

rainier[®] 2 AX

All-in-one convertible

car seat
Instruction Manual

diono

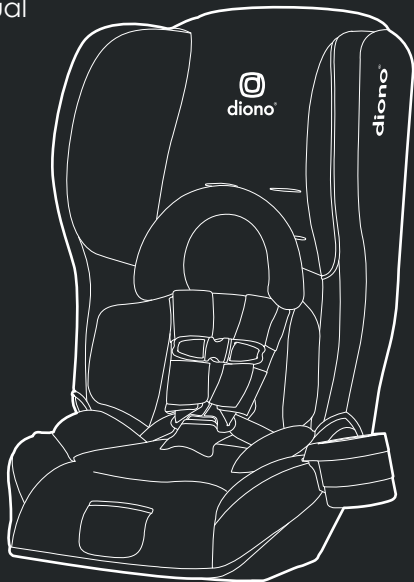

READ INSTRUCTION MANUAL
before using this child restraint

WELCOME TO THE DIONO FAMILY!

Before You Begin	3
Register this Car Seat	4
Certification	6
Safe Use Guide	7-8
Safe Use Checklist	9-10
Warnings & Safe Practices	11-15
Parts Listing	16-17
Vehicle Seating Locations	18-23
Top Tether	24-25
First Setup	26-28
REAR-FACING INSTALLATION	29-39
Rear-Facing Checklist	30-31
UAS Lower Universal Anchorage Installation	32-35
Lap/Shoulder Belt Installation	36-37
Lap Belt Installation	38-39
FORWARD-FACING INSTALLATION	40-55
Forward-Facing Checklist	41-42
UAS Lower Universal Anchorage Installation	43-47
Lap/Shoulder Belt Installation	48-51
Lap Belt Installation	52-55
Securing Your Child, Harness Setup & Adjustment	56-59
Care and Maintenance	60-61
Belt Locking Clip & Safe Stop	62-63
Harness Removal & Replacement	64-65
Aircraft Installation	66
Comfort Features	67-68
WARRANTY	70-71



WE LOVE TO HELP

Hello there, Welcome to the Diono family!
We've created this lovingly engineered car seat to help keep your child comfortable and safe with all of the goods and none of the gimmicks. We look forward to lending a helping hand each and every day :)

Any questions? 1-866-954-9786

Please take a moment to fill out the prepaid registration card attached to the harness of the seat and mail it in today or register online at: ca.diono.com/product-registration/

Child restraints could be recalled for safety reasons. You must register this restraint to be reached in a recall. Send your name, address, e-mail address if available, and the restraint's model number and manufacturing date to:

**Diono Canada ULC
50 Northland Road, Suite 400
Waterloo, Ontario N2V 1N3 Canada
or call 1-866-954-9786**

or register online at: ca.diono.com/product-registration/

For future reference, in the case of a change of address. Please take a moment to fill out the following information:

Model Name/Nom de modèle:	
Model Number/Numéro de modèle:	
Serial Number/Numéro de série:	
Manufacture Date/Date de fabrication	<div> <div>year/année</div> <div>month/mois</div> <div>day/jour</div> </div>

This information can be found either on the registration card or on the manufacturing label located on the seat.

Time. It goes so fast... Who would have thought that nearly two decades have passed since we first stepped out into the world and started a business dedicated to family travel.

Well the world has changed a lot, but we're proud to say that we haven't, (sure we've grown up), but we're still as passionate about what we do today as we were back then.

Our story is 'made of Seattle', a city like no other. This is a place where creative minds & innovators rub shoulders within a landscape of adventure; a place, where being 'a little different', is the everyday norm.

With a love for design and an understanding of modern parenting, we strive to create amazing products, so that you and your little ones can celebrate the joy in every journey.

People who own Diono products can be found in all four corners of the big blue green ball, we all call home. Some are fans & followers, some are supporters, tweeters, social media magicians, miracle moms and devoted dads.

Without your passion, pictures, words and stories, we would never hear your voice. So tell us about your patch of grass, and join in the hustle and bustle at diono.com.

share your journey **@diono social** or find the latest news.





This child restraint system conforms to all applicable requirements of Canadian Motor Vehicle Safety Standards 213 and 213.1 and is certified for use in passenger cars, multi-purpose passenger vehicles, and trucks only.



This child restraint is certified for use in aircraft only when in harness mode.

Register this restraint with the manufacturer.

Diono strongly urges you to secure your child in a child restraint system (CRS) or device for the duration of your flight. Please contact the airline for their specific policies.



WARNING – FAILURE TO FOLLOW THESE INSTRUCTIONS AND THE PRODUCT LABELS CAN RESULT IN SERIOUS INJURY OR DEATH TO YOUR CHILD.

YOUR CHILD'S SAFETY DEPENDS ON YOU. DEATH OR SERIOUS INJURY CAN OCCUR.

No car seat can guarantee protection from injury in every situation, but proper use helps to reduce the risk of serious injury or death.

Carefully read and understand all instructions and warnings in this manual. Your child's safety depends on you knowing how to setup, install and use this Child Restraint properly. Choose the correct mode of use for your child, depending on their weight and height.

This Child Restraint is designed for use only with children who weigh between 2.3–29.5 kg (5–65 lbs) and whose height is 144 cm (57 in) or less in the following modes.

- **Rear-Facing:** 2.3–18 kg (5–40 lbs) and whose height is between 46–112 cm (18–44 in).

- **Forward-Facing:** 10–29.5 kg (22–65 lbs) and whose height is between 76–144 cm (30–57 in).

- Infants who weigh less than 10 kg (22 lbs) and are under 1 year old, **MUST use this Child Restraint Rear-Facing.**

For newborn infants, you must consult the infant's doctor before using this Child Restraint. A newborn infant may have difficulty breathing or have other medical problems when placed in a seated position.

Before installing this Child Restraint in a vehicle, be sure to also check the vehicle owner's manual for information on proper installation.

Check all installation configurations before discarding the box. Diono cannot guarantee proper fit in all vehicles.



DO NOT place this Child Restraint Rear-Facing in a vehicle seating location with an active frontal air bag, unless the air bag is turned off.



Choose the proper Child Restraint Belt Path

1. REAR-FACING SECTION

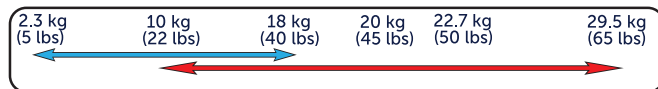

2. FORWARD-FACING SECTION



Rear-Facing with 5-Point Harness
2.3–18 kg (5–40 lbs)

Forward-Facing with 5-Point Harness
10–18 kg (22–40 lbs) with SafeStop Only
18–29.5 kg (22–65 lbs) without SafeStop

SAFE USE CHECKLIST

-  Choose a suitable location for this car seat in your vehicle. **REVIEW VEHICLE SEATING LOCATIONS.**
-  Install this car seat tightly in your vehicle. **Grab the sides of the seat where the vehicle seat belt or UAS strap is** and slide the car seat side-to-side and front-to-back. If the seat moves less than 2.5 cm (1 in), it is tight enough.
-  Secure harness snug and flat on your child.

Rear-Facing: Harness straps **MUST** be at or just below the child's shoulders. Top of head must be at least 3.8 cm (1.5 in) below the top of the car seat shell.

Forward-Facing: Harness straps **MUST** be just above the child's shoulders. Top of child's ears **MUST** be below top of car seat shell.

WARNING!



DO NOT PLACE A CHILD RESTRAINT IN THE FRONT SEAT OF A VEHICLE WITH A PASSENGER AIR BAG, UNLESS THE AIR BAG IS TURNED OFF. DEATH OR SERIOUS INJURY MAY OCCUR.

If an air bag inflates, it can hit the child or child restraint with enough force to cause serious injury or death to your child.

For vehicles with side air bags, refer to your vehicle owner's manual for information on your child restraint installation.

ALWAYS install this Child Restraint in the back seat.

The back seat is the safest place for children 12 and under. See your vehicle owner's manual for Child Restraint installations and instructions.

According to accident statistics, children are safer when properly restrained in the rear seating positions than in the front seating positions.

Child restraint systems should be securely belted to the vehicle, even when they are not occupied. In a crash an unsecured child restraint system may injure other occupants.



- **NEVER** install in rear facing, side facing or on the back of a folded down vehicle seat.
- **ALWAYS** secure this Child Restraint with the vehicle's child restraint universal anchorage system (UAS) if available OR the vehicle seat belt.
- **NEVER** use the restraint system in a vehicle seating position where it cannot be secured tightly. A loosely installed restraint system will not protect your child in a crash.
- Diono **RECOMMENDS** use of the top tether strap on this child restraint when installed Rear-Facing.
- **ALWAYS** use the top tether strap on this child restraint when installed Forward-Facing.
- **NEVER** use Child Restraint in a vehicle seating position where it cannot be secured tightly.
- **DO NOT** use this Child Restraint without the seat cover installed.



- **NEVER** leave Child Restraint unsecured in your vehicle even when it is unoccupied. It could injure other occupants in a sudden stop or crash.
- **DO NOT** use any accessories, inserts or products not included with this Child Restraint, unless approved by Diono. Items not tested with this child restraint could injure your child.
- **DO NOT** use this Child Restraint system if it has been in a vehicle accident. You **MUST** replace this Child Restraint if it has been involved in a crash, even if you cannot see visible damage. A damaged Child Restraint may not protect your child in a future crash.
- **DO NOT** modify your Child Restraint.
- **NEVER** remove harness from Child Restraint without following the proper removal and installation instructions available from Diono.

Contact us by visiting the Diono website at ca.diono.com or call 1-866-954-9786.



EXPIRATION

- **DO NOT** use the child restraint if any part is damaged or broken, expired (over 10 years from date of purchase), missing instructions, missing parts, or if the straps are cut, frayed, or damaged in any way.

Call 1-866-954-9786 to find out if the damaged part or parts can be replaced.



SAFE PRACTICES

- **DO NOT** leave loose objects, such as books, bags, etc., in the back of the vehicle. In the event of a sharp turn, sudden stop, or crash, loose objects can be thrown around and possibly cause serious injury to vehicle occupants.
- **ALWAYS** check all surfaces of restraint before securing your child. In warm weather, child restraints can become very hot. Do not allow children to play with vehicle seat belts.

rainier 2 AX

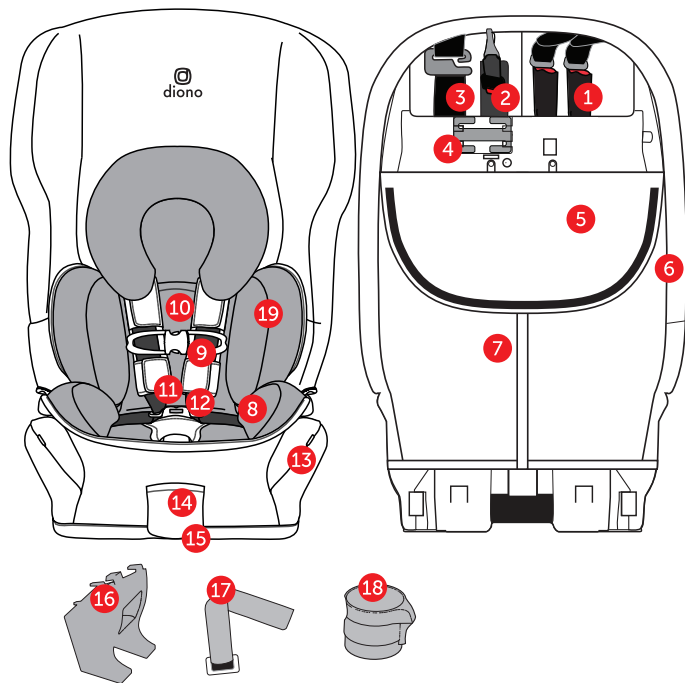

rainier 2 AX

PARTS AND FEATURES

1. UAS Lower Connector Storage
2. Top Tether
3. Safe Stop
4. Belt Locking Clip
5. Belt Storage Pocket
6. UAS Lower Connector Routing Pocket
7. Instruction Manual Storage
8. Harness Straps
9. Harness Pads
10. Chest Clip
11. Buckle
12. Buckle Pad
13. Expandable Sides
14. Harness Release
15. Harness Adjuster Strap
16. Detachable Rear-Facing Base
17. Rear-Facing Top Tether Connecting Strap
18. Cup Holder
19. Infant Support

VEHICLE SEATING LOCATIONS

The safest seating position is one that works best for your specific car seat, family and vehicle model.

Before installing this Child Restraint you must determine the method of installation and the best vehicle seating position for that method. This child restraint can be installed either using UAS or the Vehicle Seat Belt.

DO NOT install using both methods at the same time.

When determining whether the Diono AX Car Seat can be used with lower anchors in the rear centre seating position, it is critical that you refer to your vehicle owner's instruction book. If the AX does not install best in the rear centre seating location, it is recommended to move to one of the outboard seating positions.

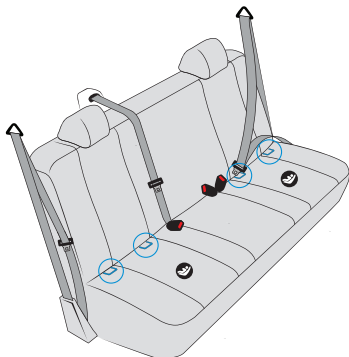

WHAT IS UAS?

Most vehicles manufactured after September 1, 2002 are equipped with UAS (Universal Anchorage System). Check your vehicle owner's instruction manual to determine UAS lower anchor compatible seating positions. Some vehicles owner's manuals use the term "ISOFIX" instead; UAS can also be used in vehicle seating systems that are equipped with ISOFIX. Look for the UAS symbol that may be visible by the crease of the rear seats.

DO NOT install using both the UAS lower anchorage connectors and the vehicle seat belt at the same time.

VEHICLE SEATING LOCATIONS

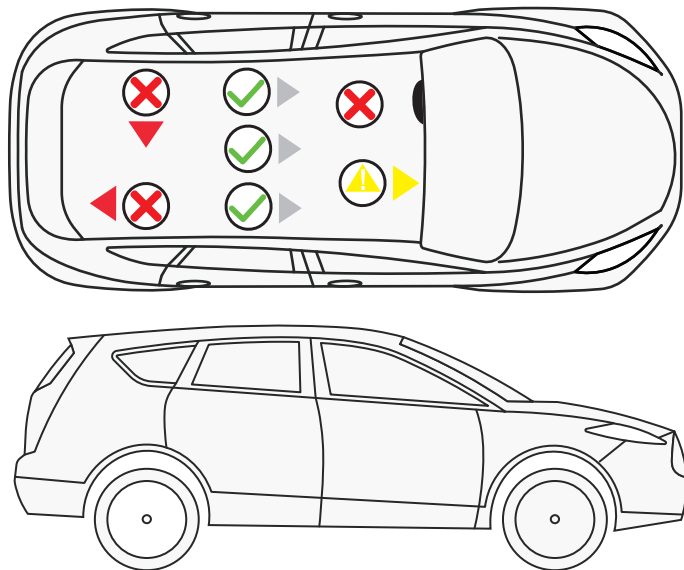

INSTALL CHILD RESTRAINT CORRECTLY

NEVER PLACE THIS CHILD RESTRAINT REAR-FACING IN A VEHICLE SEATING LOCATION WITH AN ACTIVE FRONTAL AIR BAG, UNLESS THE AIR BAG IS TURNED OFF.

If the airbag inflates, it can cause serious injury or death to your child. For vehicles with side air bags, refer to your vehicle owner's manual for information on your Child Restraint installation.

Take care to secure the child properly. Snugly adjust the belts provided with this child restraint around your child. A snug strap should not allow any slack. It lies in a relatively straight line without sagging. It does not press on the child's skin or push the child's body into an unnatural position.

- **ALWAYS** check to ensure buckle is securely latched.
- **NEVER** leave child unattended. Do not allow children to play in or around the Child Restraint. Child may become tangled in harness straps and suffocate or strangle.
- **ALWAYS** keep child properly secured in harness whenever child is in Child Restraint.

VEHICLE SEATING LOCATIONS

The following types of Vehicle Belts **CANNOT BE USED** with your child restraint.

If any of the belt types listed below are in the chosen seating position, you **MUST** choose another seating position or use UAS if available.

Please refer to your Vehicle Owners Manual for specific information about seat belts and their use with Child Restraints.

1. Motorized (Automatic) Vehicle Belts.
2. Dual Retractor Lap/Shoulder Belts
3. Non-Locking (ELR) Lap Belts
4. Inflatable Seat Belts *
5. Door Mounted Vehicle Belts

*** ONLY Ford Inflatable seat belts are allowed to be used with this Child Restraint. No other inflatable seat belts have been tested with this Child Restraint.**

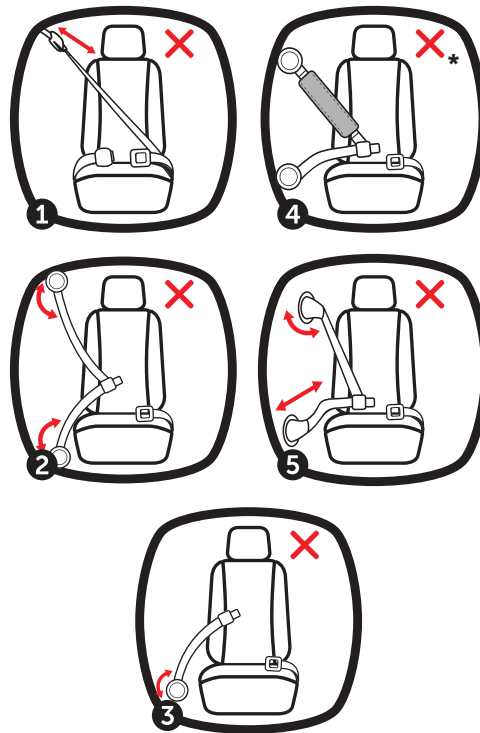

TOP TETHER

WHAT IS TOP TETHER?

A tether is designed to reduce movement of a rear-facing and forward-facing child restraint in a crash and aids in the achievement of a tight installation.

Vehicle tether locations can be found in many locations within the vehicle. Some of the typical locations are shown here. Please refer to your vehicle owner's manual for exact locations, requirements, and anchor identification points.

WARNING: Rear-facing top tether connector strap is **ONLY** to be used in rear-facing installations.

1. Locate the track of vehicle seat that is bolted directly to vehicle frame.
2. Wrap tether connecting strap around the track, and thread metal "D" ring through the loop at the end of the tether connecting strap. Pull strap to form a knot.
3. Now, use metal "D" ring as an anchorage point for top tether metal hook.

Forward-Facing Top Tether Installation

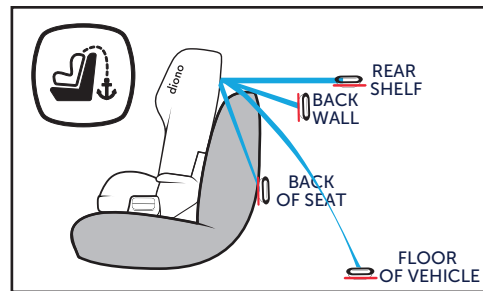

Rear-Facing Top Tether Installation

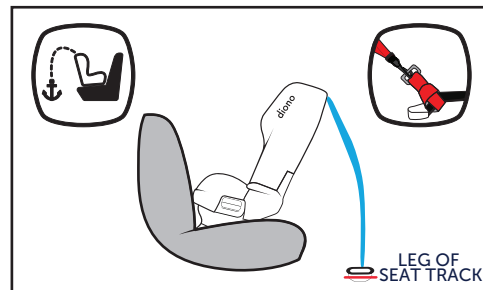

UNFOLDING AND FOLDING

1. Place car seat on its back on a flat surface and unfasten red carry strap from the bottom. Be sure the harness adjuster moves freely and is not locked within the bottom of the seat.

2. Rotate bottom until you hear it “click”, this confirms the car seat is locked for use.

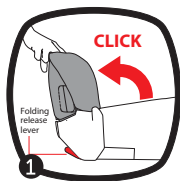

3. Check proper operation – Pull harness adjusting strap until harness begins to tighten. If it does not tighten freely, check the belt path on the back of the seat bottom is clear from obstruction. If necessary, unfold seat by releasing the levers as shown and repeat the above steps.

4. Tuck the red strap through the harness slot and store behind the cover.

5. To fold, release lever shown and secure with red strap.

HARNESS SETUP

1. Place Your Child in the Seat

Make sure their back is flat against the car seat back. (This can be done in or out of the car). Avoid bulky or heavy clothing because they will prevent the harness straps from being tightened properly at first fitment.

2. Place Harness Straps Over Child’s Shoulders and Legs Before Buckling.

You will hear a “click” when buckle tongues are securely attached. Pull up on each buckle tongue to make sure it is securely attached.

3. Be Sure the Harness Straps Are at the Proper Height.

Rear-Facing: Harness straps **MUST** be at or just below the child’s shoulders. Top of head must be at least 3.8 cm (1.5 in) below the top of the car seat shell.

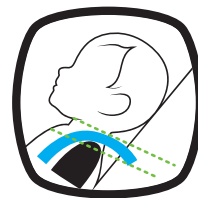

**Rear-Facing
(Harness AT or just below shoulders)**

HARNESS SETUP

Forward-Facing: Harness straps **MUST** be just above the child's shoulders. Top of child's ears **MUST** be below top of car seat shell.



Forward-Facing
(Harness just above shoulders)



**Children 10–13.6 kg
(22–30 lbs) must
use the Middle
Buckle Slot ONLY!**



**Children above 13.6 kg
(30 lbs) must use
the Forward Most
Buckle Slot ONLY!**

Check all installation configurations before discarding the box. Diono cannot guarantee proper fit in all vehicles.

REAR FACING

installation instructions



REAR-FACING INSTALLATIONS: 2.3–18 kg (5–40 lbs)

Infants who weigh less than 10 kg (22 lbs) and are under 1 year old, **MUST** use this car seat Rear-Facing.

Place car seat rear-facing in the vehicle back seat.

Make sure UAS strap or vehicle seat belt is routed through the rear-facing belt path marked with the blue label and rear-facing illustrations.

REAR-FACING BELT PATH

Make sure the vehicle is level and the vehicle seat is at the appropriate level for your child:

Infant: Use from 2.3–10 kg (5–22 lbs). Level line should fall within weight range shown noted.

Toddler: Use from 18 kg and up (40 lbs and above). Level line should fall within weight range noted.

Install this car seat tightly in your vehicle. The car seat should not move at the rear-facing belt path location by more than 2.5 cm (1 in) from side-to-side, front-to-back. If using a lap belt only, refer to your vehicles owners manual for installation advice.

Diono **RECOMMENDS** use of the top tether strap on this child restraint when installed Rear-Facing.

Harness straps **MUST** be at or just below the top of your child's shoulders. Place the chest clip at armpit level.

Diono **RECOMMENDS** that children be rear-facing until they reach the maximum rear-facing height and weight. This car seat can remain rear-facing up to 18 kg (40 lbs).

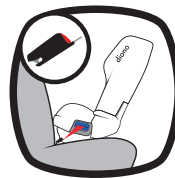

UAS Strap



Vehicle Seat
Lap/Shoulder Belt

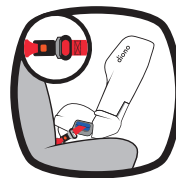

Vehicle Seat
Lap Belt

INSTALL USING UAS: 2.3–18 kg (5–40 lbs)

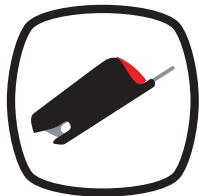

1. Install Detachable Rear-Facing Base. Align posts as shown in grey by aligning the colour coded dots. Slide the base into place to align the dots Blue to Blue, Yellow to Yellow. Once aligned, press the lever shown into the seat base to engage. Confirm base is locked and does not move.

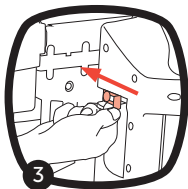
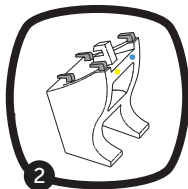
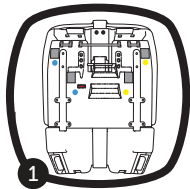

2. Remove UAS Strap from Storage Location on Back of Seat.

Fold down cover on back of car seat. Locate the UAS Strap in the belt storage location shown. Push in on the red buttons on the UAS connectors and remove from storage position **1**.

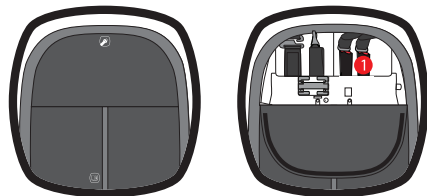

3. Extend the UAS Strap.

For easier installation, extend the UAS strap to its maximum length by pressing the grey button and pulling on the strap.

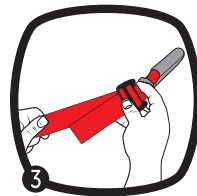

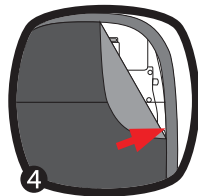

4. Place UAS for access to Rear-Facing Belt Path. Unzip the pocket to the right side of the UAS storage area, this will allow you to move the UAS connectors down to the rear-facing belt path. Feed UAS anchors down, keeping under the cover and out the bottom. Once completed, close the zip pocket.

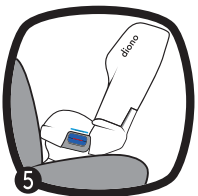

5. Place Car Seat Rear-Facing in Back Seat of the Vehicle. Place rear-facing in vehicle seat and centre the car seat between the lower UAS anchors. The entire seat bottom should sit flat on the vehicle seat.

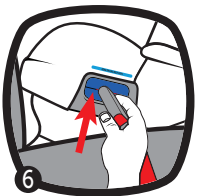

6. Locate the UAS Strap in the Rear-Facing Belt Path. Thread the UAS strap through the rear-facing belt path (marked with the blue label) and out the other side. The UAS belt should lie flat and not be twisted.

7. Attach UAS Connectors to Vehicle's Lower Anchors and listen for audible click to confirm engagement.

8. Tighten the UAS Strap. Press down firmly in the centre of the car seat while tightening the UAS strap. You may need to tighten further by pulling upwards in-line with the belt path as shown.

9. Test for Tightness. Grab the side of the seat with one hand where the UAS strap is and slide the car seat side-to-side and front-to-back. If the seat moves less than 2.5 cm (1 in), it is tight enough. Do not test by grasping top or front of the seat.

10. To Remove UAS Strap From Vehicle — Push in on the red buttons on the UAS connectors and pull them off the anchor bars.

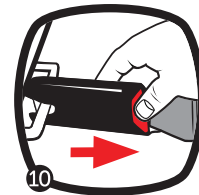
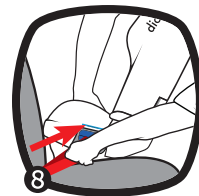
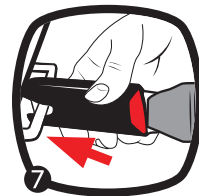

**INSTALL USING 5-POINT HARNESS WITH
LAP/SHOULDER BELT: 2.3–18 kg (5–40 lbs)**



1. Place Car Seat Rear-Facing in Back Seat of the Vehicle with Detachable Rear-Facing Base installed (Page 32). The entire seat bottom should sit flat on the vehicle seat.

2. Route the Vehicle Seat Belt.

Thread the vehicle seat belt through the rear-facing belt path (marked with the blue label) and out the other side. Buckle it. The seat belt should lie flat and not be twisted.

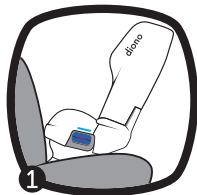

3. Tighten the Vehicle Seat Belt.

Press down firmly in the centre of the car seat. To tighten, pull on the loose end of the vehicle lap belt.

4. Test For Tightness.

Grab the side of the seat where the vehicle seat belt is and slide the car seat side-to-side and front-to-back. If the seat moves less than 2.5 cm (1 in), it is tight enough. Do not test by grasping top or front of the seat.

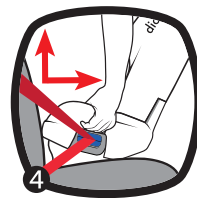
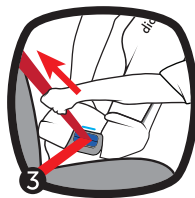

INSTALL USING 5-POINT HARNESS WITH LAP BELT: 2.3–18 kg (5–40 lbs)

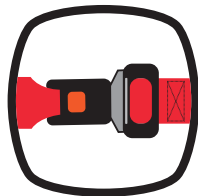

1. Place Car Seat Rear-Facing in Back Seat of the Vehicle with Detachable Rear-Facing Base installed (Page 32). The entire seat bottom should sit flat on the vehicle seat.

2. Route the Vehicle Seat Belt.

Thread the vehicle seat belt through the rear-facing belt path (marked with the blue label) and out the other side. Buckle it. The seat belt should lie flat and not be twisted.

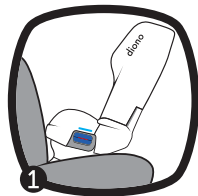

3. Tighten the Vehicle Seat Belt.

Press down firmly in the centre of the car seat. To tighten, pull on the loose end of the vehicle lap belt.

4. Test For Tightness.

Grab the side of the seat where the vehicle seat belt is and slide the car seat side-to-side and front-to-back. If the seat moves less than 2.5 cm (1 in), it is tight enough. Do not test by grasping top or front of the seat.

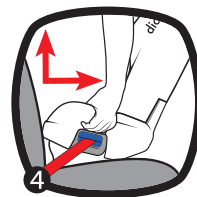
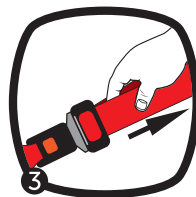

FORWARD-FACING INSTALLATIONS:
10–29.5 kg (22–65 lbs)

NOTE: If the child is **UNDER 18 kg (40 lbs)** install the Diono Safe Stop by following the instructions on page 63 before proceeding.

IMPORTANT: The Safe Stop will need to be removed once the child reaches 18 kg (40 lbs).

NOTE: If the child is **OVER 18 kg (40 lbs)**, go to Step 1 of Installation using 5-Point Harness with Lap/Shoulder Belt.

IMPORTANT: ALWAYS Use the Top Tether.

IMPORTANT: Lower the adjustable bottom by following the instructions on page 42.

DO NOT place infant in forward-facing restraint until they are at least 1 year old and weigh 10 kg (22 lbs). Diono recommends keeping children rear-facing until they are at least 2 years old.

Place car seat forward-facing in the vehicle back seat.



Lift the bottom bar up and over the inside channel toward the seat bottom to release. Confirm locked.

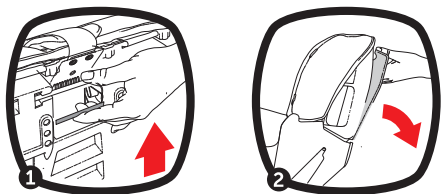

Make sure UAS strap or vehicle seat belt is routed through the forward-facing belt path marked with the red label and forward-facing illustrations.

FORWARD-FACING BELT PATH

Install this car seat tightly in your vehicle. The car seat should not move at the forward-facing belt path location by more than 2.5 cm (1 in) from side-to-side, front-to-back. If using a lap belt only, refer to your vehicles owners manual for installation advice.

Harness straps **MUST** be above the top of your child's shoulders. The chest clip should be placed at armpit level.

INSTALL USING UAS:
10–29.5 kg (22–65 lbs)

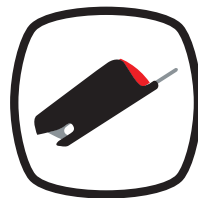

1. Remove UAS Strap from Storage Location on Back of Seat.

Fold down cover on back of car seat. Locate the UAS Strap in the belt storage location shown. Push in on the red buttons on the UAS connectors and remove from storage position **1**.

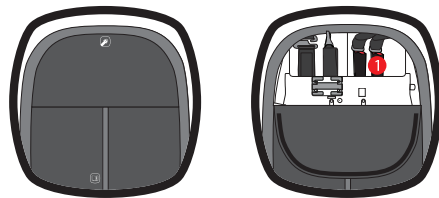

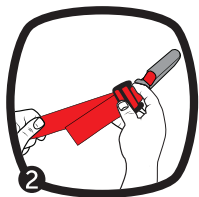

2. Extend the UAS Strap.

For easier installation, extend the UAS strap to its maximum length by pressing the grey button and pulling on the strap.

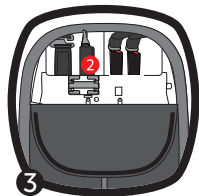

3. Unhook and Remove Top Tether Strap from Storage Location on Back of Seat.

Look for the Top Tether location **2**.

4. Place UAS in Forward-Facing Belt Path.

Unzip the pocket to the right side of the UAS storage area, this will allow you to move the UAS connectors down to the forward facing belt path. Feed UAS connectors into belt path as shown; once completed – close the zip pocket.

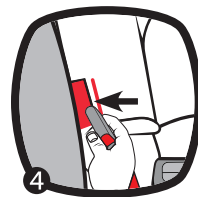

5. Place Car Seat Forward-Facing in Back Seat of the Vehicle.

Place forward-facing in vehicle seat and centre the car seat between the lower UAS anchors. The entire seat bottom should sit flat on the vehicle seat.



6. Loosely Attach Tether Strap.

Do not tighten. Consult vehicle's owner manual for specific location.

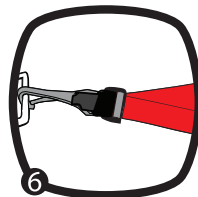



7. Locate the UAS Strap in the Forward-Facing Belt Path.

Thread UAS strap through the forward-facing belt path (marked with the red label) and out the other side. The UAS connectors are easier to feed through by pulling forward on the front cover as shown.



8. Attach UAS Connectors to Vehicle's Lower Anchors and listen for audible click to confirm engagement. UAS strap should lie flat and not be twisted.



9. Tighten the UAS Strap.

Press down firmly in the centre of the car seat while tightening the UAS strap. You may need to tighten through the opening in the pad at the belt path as shown, by pulling it through and up.

10. Test for Tightness.

Grab the side of the seat with one hand where the UAS strap is and slide the car seat side-to-side and front-to-back. If the seat moves less than 2.5 cm (1 in), it is tight enough. Do not test by grasping top or front of the seat.

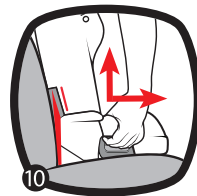

11. Tighten the Top Tether Strap.

Push the car seat back while tightening the tether strap to remove all the slack.

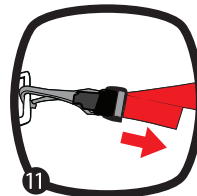

12. To Remove UAS Strap From Vehicle, push in on the red buttons on the UAS connectors and pull them off the anchor bars.

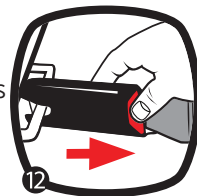

13. To Loosen or Remove the Top Tether, push in on the grey button to loosen, then unclip the top tether.

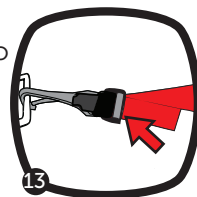

**INSTALL USING 5-POINT HARNESS WITH
LAP/SHOULDER BELT: 10–29.5 kg (22–65 lbs)**



1. Unhook and Remove Top Tether from Storage Location on back of seat.

Look for the Top Tether location **2**.

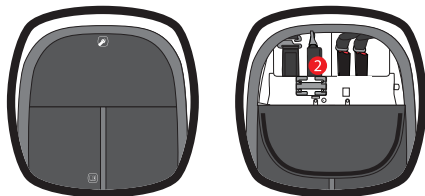

2. Place Car Seat Forward-Facing in Back Seat of the Vehicle.

The entire seat bottom should sit as flat as possible on the vehicle seat.



3. Loosely Attach Top Tether Strap.

Do not tighten. Consult vehicle's owner manual for specific location

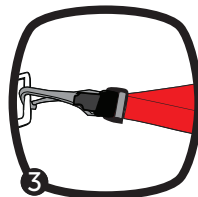

4. Route the Vehicle Seat Belt.

Thread the vehicle seat belt through the forward-facing belt path (marked with the red label) and out the other side. Buckle it. The seat belt should lie as flat as possible and not be twisted.





5. Tighten the Vehicle Seat Belt.

In most vehicles today, slowly pull the shoulder belt all the way out and then let it go back in. You will hear a clicking sound as the belt retracts. Slowly pull out on the belt and it should be locked. If not, please review your car's owner manual.

Press down firmly in the centre of the car seat. To tighten, pull from the shoulder belt on the side **nearest to the buckle** while feeding the slack back in the retractor.

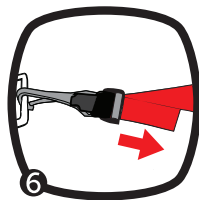

6. Tighten the Top Tether Strap.

Push the car seat back while tightening the tether strap to remove all the slack.

7. Test For Tightness.

Grab the side of the seat with one hand where the seat belt strap is and slide the car seat side-to-side and front-to-back. If the seat moves less than 2.5 cm (1 in), it is tight enough. Do not test by grasping top or front of the seat.

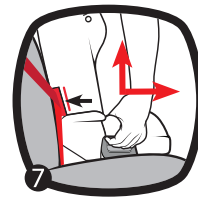

INSTALL USING 5-POINT HARNESS WITH LAP BELT: 10–29.5 kg (22–65 lbs)

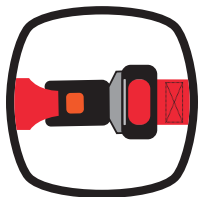

1. Unhook and Remove Top Tether from Storage Location on Back of Seat.

Look for the Top Tether location **2**.

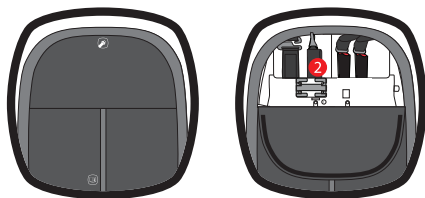

2. Place Car Seat Forward-Facing in Back Seat of the Vehicle.

The entire seat bottom should sit as flat as possible on the vehicle seat.



3. Route the Vehicle Seat Belt.

Thread the vehicle seat belt through the forward-facing belt path (marked with the red label) and out the other side. Buckle it. The seat belt should lie as flat as possible and not be twisted.

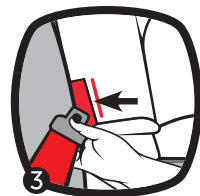

4. Loosely Attach Top Tether Strap.

Do not tighten. Consult vehicle's owner manual for specific location.

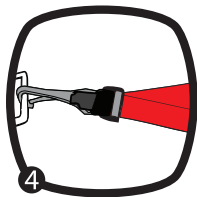

5. Tighten the Vehicle Seat Belt.

Press down firmly in the center of the car seat. To tighten, pull on the loose end of the vehicle lap belt.



6. Tighten the Top Tether Strap.

Push the car seat back while tightening the tether strap to remove all the slack.

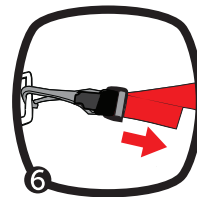

7. Test for Tightness.

Grab the side of the seat on the buckle side with one hand where the vehicle seat belt strap is and slide the car seat side-to-side and front-to-back. If the seat moves less than 2.5 cm (1 in), it is tight enough. Do not test by grasping top of the seat.

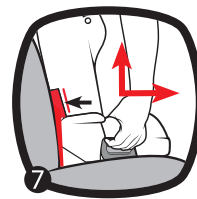

INITIAL SETUP

1. Place Your Child in the Seat.

Make sure their back is flat against the car seat back. (This can be done in or out of the car). Avoid bulky or heavy clothing because they will prevent the harness straps from being tightened properly at first fitment.

2. Place Harness Straps Over Child's Shoulders and Legs Before Buckling.

You will hear a "click" when buckle tongues are securely attached. Pull up on each buckle tongue to make sure it is securely attached.

3. Be Sure the Harness Straps are at the Proper Height.

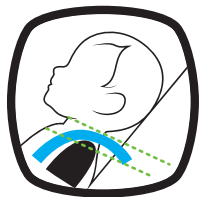

Rear-Facing
(Harness AT or just
below shoulders)



Forward-Facing
(Harness just
above shoulders)

HARNESS SETUP

1. Loosen Harness Straps.

Lift up on the harness adjuster while pulling out on the harness straps at the chest clip. Unbuckle the chest clip and the centre buckle. Place harness straps off to the sides.

2. Place Your Child in the Seat.

Make sure their back is flat against the car seat back. Avoid bulky or heavy clothing. Doing so will prevent the harness straps from being tightened properly.

3. Place Harness Straps Over Child's Shoulders and Legs Before Buckling.

You will hear a "click" when buckle tongues are securely attached. Pull up on each buckle tongue to make sure it is properly secured.

NOTE: The addition or removal of clothing will change the fit of the harness, especially bulky winter jackets. Diono recommends harnessing your child first and placing a blanket over them or putting their jacket on backwards.

CHANGING HARNESS POSITION

1. First Loosen the Harness Straps.

Lift up on the harness release lever while pulling out on the harness straps at the chest clip. Unbuckle the chest clip. Detach the buckle tongues from the centre buckle.

2. Remove Harness Straps from Metal Plate.

On back of seat, detach harness from metal plate. Once detached, pull each harness through to the front of the seat. Re-locate each harness to the correct slot determined, push through to the back of the seat taking care to keep each harness strap flat. Re-secure the Harness Straps to the Metal Plate. Check to ensure proper engagement to the metal plate.

3. Check the Centre Buckle Position.

When rear-facing, the correct slot is the one that is closest to your child without being underneath your child. When forward-facing, children 10–13.6 kg (22–30 lbs) **MUST** use the middle buckle slot only. Children above 13.6 kg (30 lbs) **MUST** use the forward most buckle slot only.

4. To Adjust Centre Buckle Strap — Remove all lower seat cover clips.

Reach into the Rear-Facing Belt path slot marked in blue. You will feel the buckle strap metal retainer.

5. Rotate Metal Retainer and Insert It Up Through the Shell and Pad.

From the top of the car seat, pull the buckle strap out.

6. Insert Metal Retainer in the New Buckle Slot Position.

Reach underneath the car seat and pull the metal retainer through.

SECURING YOUR CHILD

1. Pull Up on Centre Buckle Strap to Make Sure it is Secured.

2. Pull All the Slack Out From Around the Waist.

Pull up on the harness strap while pushing the chest clip down. Do this to both sides.

3. Tighten the Harness by Pulling the Harness Adjustment Strap.

When you are not able to pinch any of the harness webbing at your child's shoulder, the harness is tight enough. A snug harness should not allow any slack. It lies in a relatively straight line without sagging. It does not press on the child's flesh or push the child's body into an unnatural position.

4. Buckle the Chest Clip.

You will hear a "click" when the chest clip is securely buckled.

5. Place the Chest Clip at Armpit Level.

CLEANING FABRICS: Seat pad, Infant support, Buckle pad and Shoulder pads.

Machine wash in cold water on gentle cycle with mild detergent. Dry flat and away from direct sunlight before re-use or storage. **REMOVE** blue memory foam insert from seat pad prior to washing. Do not wash.

DO NOT bleach, iron or dry clean.

CLEANING HARNESS: Buckles, Harness, and Buckle straps.

Spot clean using warm water with mild detergent. Air dry completely before re-use or storage.

DO NOT bleach or iron.

CLEANING PLASTIC: Spot clean using warm water with mild detergent. Towel dry completely before re-use or storage. **DO NOT** bleach.

CLEANING BUCKLE, SEAT FRAME AND LOWER ANCHOR CONNECTOR HARDWARE

NOTE: Buckle should fasten with a "click" if not, rinse under warm running water. **DO NOT** use detergents or lubricants.

CLEANING FABRICS: Seat Pad, Infant Support, Harness and Buckle Pad.



Machine wash in cold water on gentle cycle. Use mild detergent.



Dry flat and in the shade only.



DO NOT bleach, iron or dry clean.

CLEANING HARNESS: Buckles, Harness and Buckle Straps.



Spot clean only with warm water. Use mild detergent.



Dry flat and in the shade only, before re-use.



DO NOT bleach or iron.

CLEANING PLASTICS: Seat Shell and Components.



Spot clean only with warm water. Use mild detergent.



Towel dry completely before re-use.



DO NOT bleach.

WARNING: If your vehicle's lap/shoulder seatbelt is equipped with ELR (Emergency Locking Retractor) that does not switch to function as an ALR (Automatic Locking Retractor), you **MUST** use a locking clip to secure lap portion of vehicle seat belt. If you have any questions; please consult your vehicle owner's manual or contact the vehicle manufacturer.

1. Remove Lock Clip from Belt Storage Pocket.

2. Route the vehicle seat belt through the proper belt path and buckle it in. While pushing down on seat, pinch the two straps together behind the buckle tongue. Unbuckle the belt without allowing it to slip.

3. Attach locking clip to lap and shoulder belts as shown. Rebuckle belt. Check that lap belt does not move by pulling hard. If belt loosens or lengthens, repeat procedure.

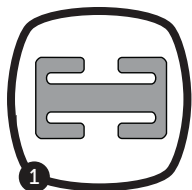

1

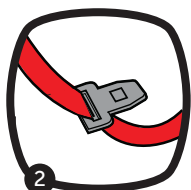

2



3

ONLY for use in Forward-Facing Installations from 10–18 kg (22–40lbs). DO NOT use Rear-Facing.

1. Look for the Belt Storage Icon on the back of the seat and fold down the rear Velcro flap. Detach the Safe Stop and remove it for use.

2. Remove Harness Straps from Metal Plate — Unzip cover on back of seat, detach harness from metal plate. Once detached, thread both harness straps onto the metal hook of the Safe Stop. Connect left side of harness first, then follow with the right.

3. Thread bottom of Safe Stop onto the metal hook of harness adjuster. Check to ensure proper engagement to the metal plate. Close cover on back of seat, taking care to ensure the strap is clear from any obstruction.

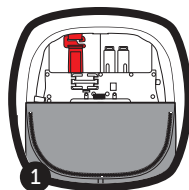

1



2

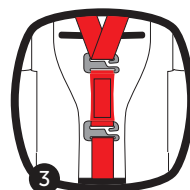

3

- 1. Unzip Back Seat Cover to access harness.** Remove harness straps from the metal hook.
- 2. Pull the harness straps out from the back of the seat.** Remove the Harness Pads and Chest Clip from each side. Slide the harness strap out of the buckle tongues.
- 3. Using a Phillips head screwdriver, take out the screws and remove the access panel shown.** Remove old harness straps from seat.
- 4. Insert new harness strap through the slot shown and pull the strap up.**
- 5. Once the strap is pulled up until the metal "D" ring is located as shown, re-fasten and close the access panels in step 3.**

Slide the new harness straps through the buckle tongues, re-attach the chest clip and reinstall the harness pads.

Slide the harness straps through to the back of the seat and re-install them to the metal hook in Step 1.

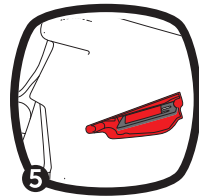
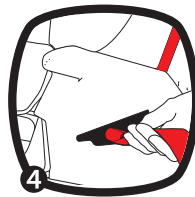
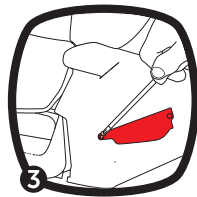
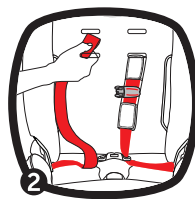
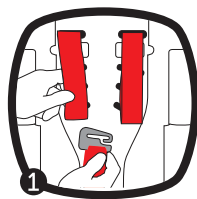

AIRCRAFT INSTALLATION

REAR-FACING INSTALLATION

1. Adjust the seat belt buckle to its shortest length to ensure the buckle is accessible for release.
2. Ask the flight attendant for a "seat belt extender" and then use this extender to adjust the seat belt length.
3. Following the instructions in Rear-Facing installation section for use with a Lap Belt to complete.



FORWARD-FACING INSTALLATION

1. Follow the instructions in the Forward-Facing installation section for use with a Lap Belt.



INFANT SUPPORT - SIDE WINGS

INFANT SUPPORT USE

1. To ensure a better fit for smaller infants, we recommend using the infant head and body support cushions included with your car seat. Use of these cushions is optional and does not affect the safety of the seat.

Slide the buckle through the bottom buckle slot on the infant insert that matches the slot chosen on the seat.

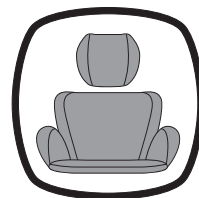

ADJUSTING EXPANDABLE SIDE WINGS

1. The side wings can be adjusted for comfort as shown. These will not impact the safety of the car seat in any manner. Simply push the side wings outward as shown to extend.

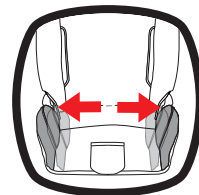

1. To attach your cup holder, locate the cup holder tab attached on the side of your preference.
2. Align the tab on the cup holder with the slot in the seat as shown. Push down to securely engage the cupholder into the slot and twist to firmly lock in place.

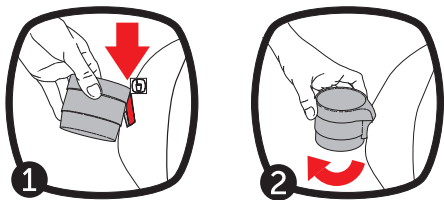
[illegible]

Diono Canada, ULC ("Diono") warrants its proprietary products to the original retail purchaser as follows (the "Warranty"):

LIMITED ONE-YEAR WARRANTY This product is warranted against defective materials or workmanship for one year from the date of original purchase. Proof of purchase is required. The exclusive remedy for this Warranty is that Diono will, at its sole option, provide repair or replacement components for this product or refund the original purchase price of the product. Diono reserves the right to discontinue or change fabrics, parts, models or products, or to make substitutions. To make a claim under this Warranty, contact Diono Consumer Services at 1-866-954-9786 or email: DionoCA@diono.com. Click "Register Your Car Seat" on the top right of the page or PLEASE COMPLETE AND MAIL THE OWNER REGISTRATION CARD WITHIN (30) DAYS OF PURCHASE. DIONO MAKES NO EXPRESS OR IMPLIED WARRANTIES OR CONDITIONS OF ANY KIND OR NATURE, EXCEPT THOSE STATED IN THIS SECTION AND IN DIONO'S APPLICABLE LIMITED WARRANTY STATEMENT IN EFFECT ON THE DATE OF THE INVOICE. DIONO DISCLAIMS ALL OTHER WARRANTIES AND CONDITIONS, EXPRESS OR IMPLIED, INCLUDING WITHOUT LIMITATION IMPLIED WARRANTIES AND CONDITIONS OF MERCHANTABILITY, FITNESS FOR A PARTICULAR PURPOSE AND NON INFRINGEMENT. Any claim or action commenced by the purchaser under this Warranty must be brought within one year from the date of original retail purchase, and purchaser agrees that any disputes shall be brought in and before a court located in the Province of Ontario to the exclusion of the courts of any other province.

WARRANTY LIMITATIONS This Warranty excludes damages which arise from negligence, misuse or use of this product not in accordance with the product's instructions, fire, floods, acts of God, or damage caused by alteration after completion of the installation of the product. The use of non-Diono covers, inserts, toys, accessories, or tightening devices is not approved by Diono. Their use could

cause this restraint to fail Federal Safety Standards or perform worse in a crash. Their use automatically voids this Warranty.

LIMITATION OF LIABILITY TO THE MAXIMUM EXTENT PERMITTED BY LAW, IN NO EVENT SHALL DIONO BE LIABLE FOR ANY PRE-TRIAL PECUNIARY LOSS (IN THE PROVINCE OF QUÉBEC), SPECIAL (IN ANY OTHER PROVINCE), INCIDENTAL, PUNITIVE, INDIRECT OR CONSEQUENTIAL DAMAGES, WHATSOEVER ARISING OUT OF THE USE OR INABILITY TO USE THE PRODUCT, EVEN IF DIONO HAS BEEN ADVISED OF THE POSSIBILITY OF SUCH DAMAGES. IN NO EVENT WILL DIONO BE OBLIGATED TO PAY DAMAGES TO ORIGINAL RETAIL PURCHASER FOR ANY AMOUNT EXCEEDING THE PRICE THAT PURCHASER PAID FOR THE PRODUCT.

This warranty gives you specific legal rights, and you may have other rights, which vary from province to province. Neither Diono, nor the retailer selling this product, authorizes any person to create for it any other warranty, obligation, or liability in connection with this product. This warranty information can also be found in the Diono User Guide you received with your child restraint.

AUTHORIZED RETAILERS Please visit your nearest authorized Diono retailer or authorized online retailer to purchase your Diono products. A list of Diono authorized retailers can be found on our website. Not all products are available at all retailers. Diono products purchased from unauthorized retailers, online auction sites, or as second hand items, are not covered under warranty. Proof of purchase may be required. While this Warranty may not be honored, replacement parts can be purchased.

diono®

#madeofseattle

share your journey @diono social
or find the latest news.



Diono Canada ULC, 50 Northland RD, Suite 400
Waterloo, Ontario N2V 1N3 Canada
Tel: 1-866-954-9786 | Made in China | diono.com
#DI-000103A

©2018 Diono LLC. All rights reserved.
revised 20191101